

## Hammer-in anchor

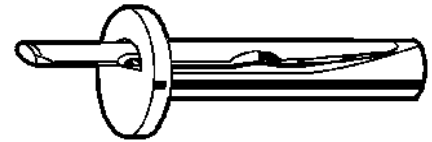
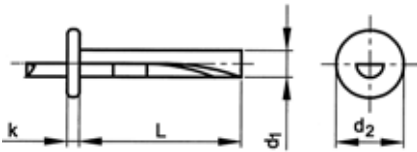

### Technical data

Type	SDA 6
d <sub>1</sub>	5,8
d <sub>2</sub>	15
k	2,5
L	35
Drill ø	6
Drill depth (min.)	40
Grip range (max.)	4,5
Allowable load in kN	
Concrete ≥ C20/25	0,5

- Loads are valid in the pressure zone.

### Assembly sequence

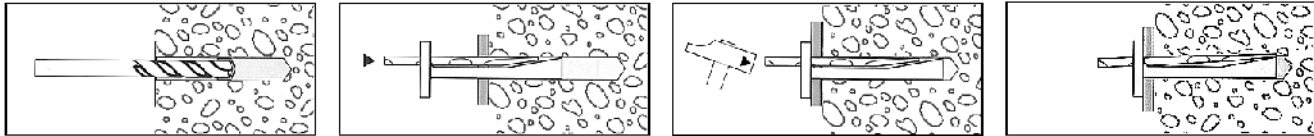

### 70665 SPIT Hammer-in anchor type SDA

P03A

Material Steel  
Surface treatment Zinc plated yellow passivated  
Packaging Standard

**spit**

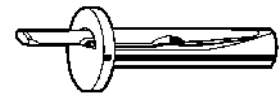

Type	✉	Art.number	Type	✉	Art.number	Type	✉	Art.number
SDA 6		100			<a href="#">70665.060.001</a>			

## Nail sleeve

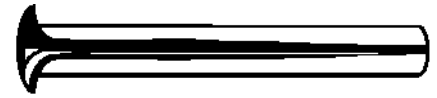
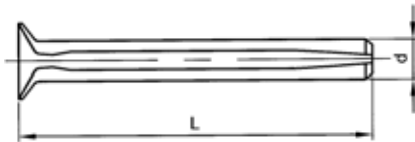

### Technical data

Type	FNH 5/50	FNH 6/40	FNH 6/50	FNH 6/60	FNH 6/80	FNH 8/70	FNH 8/90	FNH 8/110	FNH 8/130	FNH 8/150
d	5	6	6	6	6	8	8	8	8	8
L	50	40	50	60	80	70	90	110	130	150
Drill ø	5	6	6	6	6	8	8	8	8	8
Drill depth (min.)	30	40	40	40	40	50	50	50	50	50
Grip range (max.)	30	10	20	30	50	30	50	70	90	110
Allowable load in kN										
Concrete ≥ C20/25	0,2	0,55	0,55	0,55	0,55	1,1	1,1	1,1	1,1	1,1

- A DACROMET® surface coating eliminates the possibilities of damage which can arise due to hydrogen embrittlement.
- Drill depth (min.) For through fixing.
- Concrete ≥ B25 Recommended load for non-cracked concrete.

### Assembly sequence

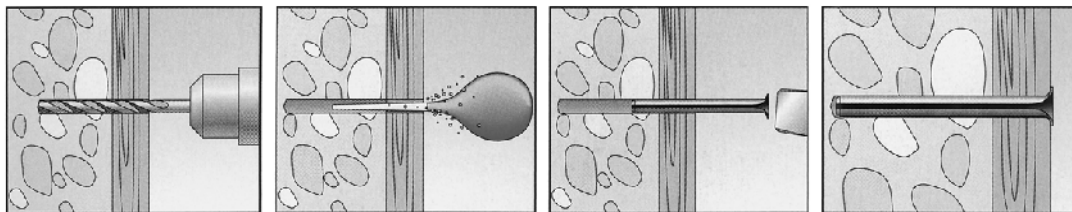

### 63223 FISCHER Nail sleeve type FNH

N03A

**Material** Steel  
**Surface treatment** Dacromet 500 LC Grade A  
**Packaging** Standard



Type	☒	Art.number	Type	☒	Art.number	Type	☒	Art.number
FNH 5/50	100	<a href="#">63223.050.050</a>	FNH 6/80	100	<a href="#">63223.060.080</a>	FNH 8/130	100	<a href="#">63223.080.130</a>
FNH 6/40	100	<a href="#">63223.060.040</a>	FNH 8/70	100	<a href="#">63223.080.070</a>	FNH 8/150	50	<a href="#">63223.080.150</a>
FNH 6/50	100	<a href="#">63223.060.050</a>	FNH 8/90	50	<a href="#">63223.080.090</a>			
FNH 6/60	100	<a href="#">63223.060.060</a>	FNH 8/110	50	<a href="#">63223.080.110</a>			

## Wall plug HammerFast

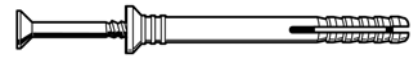
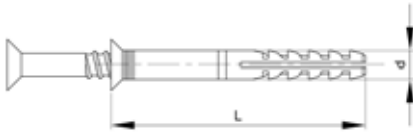

### Technical data

d x L	5x30	5x35	5x50	6x40	6x50	6x60	8x60	8x80	8x100	8x120
Drill ø	5	5	5	6	6	6	8	8	8	8
Drill depth (min.)	50	55	70	60	70	80	80	100	120	140
Grip range	5	10	25	10	20	30	20	40	60	80
<b>Pull-out force in kN</b>										
Concrete ≥ C20/25	0,32	0,32	0,32	0,36	0,36	0,36	0,44	0,44	0,44	0,44
Brick ≥ Mz12	0,20	0,20	0,20	0,28	0,28	0,28	0,36	0,36	0,36	0,36

### 30510 MAXXFAST Wall plug HammerFast

MF50

<b>Material</b>	Plastic Nylon (polyamide)
<b>Surface treatment</b>	Zinc plated
<b>Colour</b>	Grey
<b>Packaging</b>	Standard

**MAXXFAST**  
PROFESSIONAL HARDWARE



d x L	☒	Art.number	d x L	☒	Art.number	d x L	☒	Art.number
5X30MM	100	<a href="#">30510.050.030</a>	6X50MM	100	<a href="#">30510.060.050</a>	8X100MM	50	<a href="#">30510.080.100</a>
5X35MM	100	<a href="#">30510.050.035</a>	6X60MM	100	<a href="#">30510.060.060</a>	8X120MM	50	<a href="#">30510.080.120</a>
5X50MM	100	<a href="#">30510.050.050</a>						
6X40MM	100	<a href="#">30510.060.040</a>	8X60MM	100	<a href="#">30510.080.060</a>			
			8X80MM	50	<a href="#">30510.080.080</a>			

## Hammerfix type N-Z

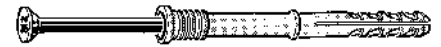
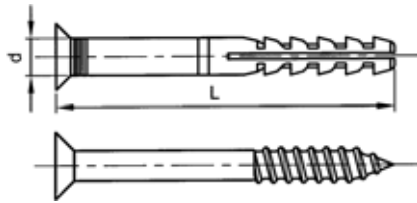

### Technical data

Type	N5x30 Z	N5x40 Z	N5x50 Z	N6x40 Z	N6x60 Z	N6x80 Z	N8x60 Z	N8x80 Z	N8x100 Z	N8x120 Z	N10x100 Z	N10x135 Z	N10x160 Z
d	5	5	5	6	6	6	8	8	8	8	10	10	10
L	30	40	50	40	60	80	60	80	100	120	100	135	160
Nail dimension	3,5x38	3,5x48	3,5x58	4x48	4x64	4x88	5x65	5x85	5x105	5x120	7x110	7x145	7x170
Drill ø	5	5	5	6	6	6	8	8	8	8	10	10	10
Drill depth (min.)	45	55	65	55	75	95	75	95	115	135	115	150	175
Grip range (max.)	5	15	25	10	30	50	20	40	60	80	50	85	110
Pull-out force in kN													
Concrete C20/25	1,1	1,1	1,1	1,4	1,4	1,4	1,9	1,9	1,9	1,9	3,4	3,4	3,4
Brick Mz12	1	1	1	1,2	1,2	1,2	1,7	1,7	1,7	1,7	3	3	3
Pumice grit V4	0,2	0,2	0,2	0,8	0,8	0,8	0,9	0,9	0,9	0,9	1,1	1,1	1,1
Sandlime brick KS12	1	1	1	1,2	1,2	1,2	1,7	1,7	1,7	1,7	3	3	3
Cellular concrete G2	0,2	0,2	0,2	0,25	0,25	0,25	0,5	0,5	0,5	0,5	0,7	0,7	0,7
Cellular concrete G4	0,5	0,5	0,5	0,65	0,65	0,65	0,8	0,8	0,8	0,8	1,2	1,2	1,2

- With pre-assembled steel zinc plated, yellow passivated nail or stainless steel A2 nail with Pozidriv (Z) cross recessed head.
- It is advised to take a safety factor:  $\geq 7$ .

### Assembly sequence

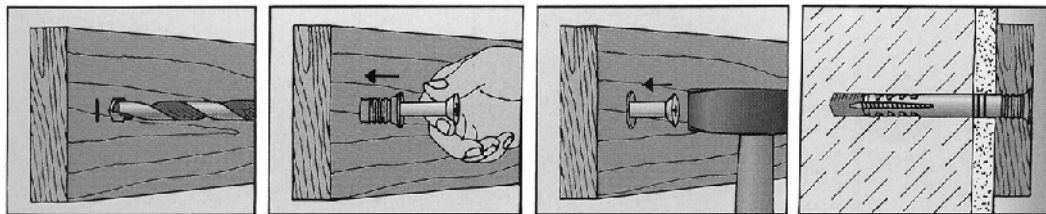

### Article groups

Material	Surface treatment	Colour	Packaging	Code	Page
Plastic Nylon	Zipl	Grey	Standard	63611	8-28
Plastic Nylon		Grey	Standard	63616	8-29

### 63611 FISCHER Hammerfix type N-Z

N03C

Material	Plastic Nylon (polyamide)
Surface treatment	Zinc plated
Colour	Grey
Packaging	Standard



Type	☒	Art.number	Type	☒	Art.number	Type	☒	Art.number
N 5X30MM	100	<a href="#">63611.050.030</a>	N 5X50 WT	100	<a href="#">63611.050.511</a>	N 8X100MM	50	<a href="#">63611.080.100</a>
N 5X30 BR	100	<a href="#">63611.050.031</a>	N 6X40MM	50	<a href="#">63611.060.040</a>	N 8X120MM	50	<a href="#">63611.080.120</a>
N 5X40 BR	100	<a href="#">63611.050.040</a>	N 6X60MM	50	<a href="#">63611.060.060</a>	N 10X100MM	50	<a href="#">63611.100.100</a>
N5X40Z	100	<a href="#">63611.050.041</a>	N 6X80MM	50	<a href="#">63611.060.080</a>	N 10X135MM	50	<a href="#">63611.100.135</a>
N 5X50MM	100	<a href="#">63611.050.050</a>	N 8X60MM	50	<a href="#">63611.080.060</a>	N 10X160MM	50	<a href="#">63611.100.160</a>
N 5X40 WT	100	<a href="#">63611.050.411</a>	N 8X80MM	50	<a href="#">63611.080.080</a>			

<b>63616 FISCHER Hammerfix type N-Z St.st. A2</b>		<b>N03C</b>
<b>Material</b>	Plastic Nylon (polyamide)	 
<b>Colour</b>	Grey	
<b>Packaging</b>	Standard	

Type	☒	Art.number	Type	☒	Art.number	Type	☒	Art.number
5X30MM	100	<a href="#">63616.050.030</a>	6X60MM	50	<a href="#">63616.060.060</a>	8X80MM	50	<a href="#">63616.080.080</a>
6X40MM	50	<a href="#">63616.060.040</a>	8X60MM	50	<a href="#">63616.080.060</a>	8X100MM	50	<a href="#">63616.080.100</a>

## Hammerfix type N-FZ

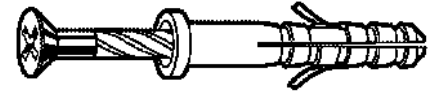
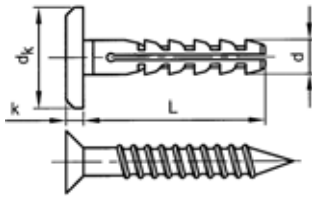

### Technical data

Type	N6x40 FZ	N8x40 FZ
d	6	8
L	40	40
dk	13	20
Nail dimension	4x48	5x45
Drill ø	6	8
Drill depth (min.)	55	55
Grip range (max.)	7	0,5
Pull-out force in kN		
Concrete C20/25	1,4	1,9
Brick Mz12	1,2	1,7
Pumice grit V4	0,8	0,9
Sandlime brick KS12	1,2	1,7
Cellular concrete G2	0,25	0,5
Cellular concrete G4	0,65	0,8

### Assembly sequence

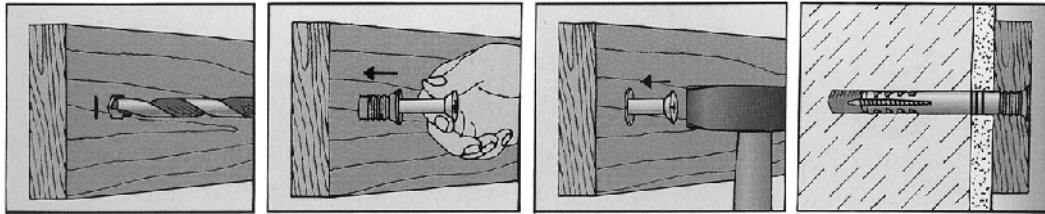

63615 FISCHER Hammerfix type N-FZ

N03C

Material Plastic Nylon (polyamide)  
Colour Grey  
Packaging Standard

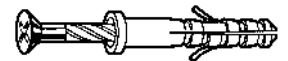

8

Type	☒	Art.number	Type	☒	Art.number	Type	☒	Art.number
N 6X40 FZ	50	<a href="#">63615.060.040</a>						
N 8X40 FZ	50	<a href="#">63615.080.040</a>						

## Hammerfix with isolating washer

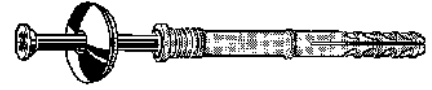
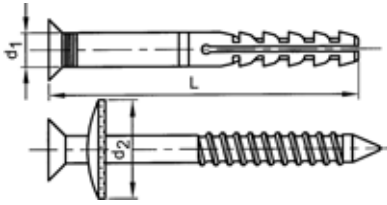

### Technical data

Type	N6x40 D	N6x60 D
d <sub>1</sub>	6	6
L	40	60
d <sub>2</sub>	19	19
Nail dimension	4x48	4x64
Drill ø	6	6
Drill depth (min.)	55	75
Grip range (max.)	10	30
Pull-out force in kN		
Concrete C20/25	1,4	1,4
Brick Mz12	1,2	1,2
Pumice grit V4	0,8	0,8
Sandlime brick KS12	1,2	1,2
Cellular concrete G2	0,25	0,25
Cellular concrete G4	0,65	0,65

- Pull-out force in kN.
- It is advised to take a safety factor  $\geq 7$ .

### 63617 FISCHER Hammerfix with isolating washer type N-D

N03C

**Material** Plastic Nylon (polyamide)  
**Colour** Grey  
**Packaging** Standard



Type	✉	Art.number	Type	✉	Art.number	Type	✉	Art.number
6X40MM	50	<a href="#">63617.060.040</a>						
6X60MM	50	<a href="#">63617.060.060</a>						

- With pre-assembled stainless steel A2 nail with Pozidriv (Z) cross recess and with stainless steel A2/elastomer isolating washer.

## Long-shaft fixing

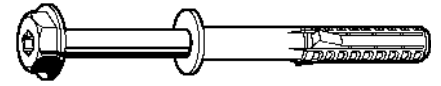
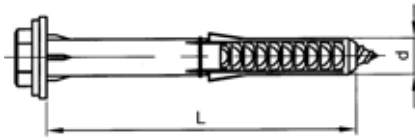

### Technical data

Type	SX 10x80 T	SX 10x100 T	SX 10x140 T	SX 10x160 T	SXS 10x60 F US A4	SXS 10x80 F US A4	SXS 10x100 F US A4	SXS 10x120 F US A4	SXS 10x140 F US A4	SXS 10x160 F US A4	SXS 10x200 SS A4	SXS 10x260 SS A4
d	10	10	10	10	10	10	10	10	10	10	10	10
L	80	100	140	160	60	80	100	120	140	160	200	260
Screw size	7x87	7X107	7X147	7x167	7x69	7x89	7x109	7x129	7x149	7x169	7x207	7x267
Socket	No.40	No.40	No.40	No.40	No.40	No.40	No.40	No.40	No.40	No.40	No.40	No.40
Drill ø	10	10	10	10	10	10	10	10	10	10	10	10
Drill depth (min.)	90	110	150	170	70	90	110	130	150	170	210	270
Grip range (max.)	30	50	90	110	10	30	50	70	90	110	150	210
Allowable load in kN												
Concrete ≥ C12/15	0,8/1,2/ 1,6	0,8/1,2/ 1,6	0,8/1,2/ 1,6	0,8/1,2/ 1,6	0,8/1,2/ 1,6	0,8/1,2/ 1,6	0,8/1,2/ 1,6	0,8/1,2/ 1,6	0,8/1,2/ 1,6	0,8/1,2/ 1,6	0,8/1,2/ 1,6	0,8/1,2/ 1,6
Brick ≥ Mz12	0,6	0,6	0,6	0,6	0,6	0,6	0,6	0,6	0,6	0,6	0,6	0,6
Sandlime brick ≥ KS12	0,6	0,6	0,6	0,6	0,6	0,6	0,6	0,6	0,6	0,6	0,6	0,6
Hollow block ≥ Hbl2	0,25	0,25	0,25	0,25	0,25	0,25	0,25	0,25	0,25	0,25	0,25	0,25

- Load varies with the edge distance, see the approval.
- For further technical data the approval is available on request.

### Assembly sequence

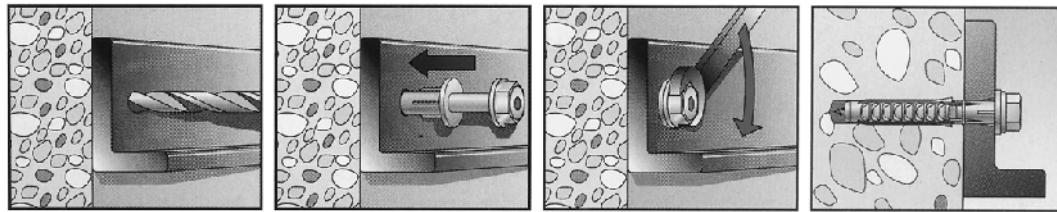

### Article groups

Material	Colour		Packaging	Code	Page
Plastic	Grey	SXS-F US A4	Standard	63174	8-32
Plastic	Grey	SXS-T	Standard	63298	8-33

#### 63174 FISCHER Long-shaft fixing type SXS-F US A4

N03A

Material Plastic  
Colour Grey  
Packaging Standard

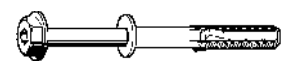

Type	✉	Art.number	Type	✉	Art.number	Type	✉	Art.number
10X60	50	<a href="#">63174.100.060</a>	10X120	50	<a href="#">63174.100.120</a>			
10X80	50	<a href="#">63174.100.080</a>	10X140	50	<a href="#">63174.100.140</a>			
10X100	50	<a href="#">63174.100.100</a>	10X160	50	<a href="#">63174.100.160</a>			

- Fixing with collar ø 18 x 2 mm, with pre-assembled stainless steel A4 hexagon head screw with hexalobular and with integrated washer.



63298 FISCHER Long-shaft fixing type SXS-T

N03A

Material Plastic  
Colour Grey  
Packaging Standard

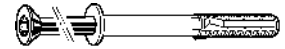

**Assembly sequence**

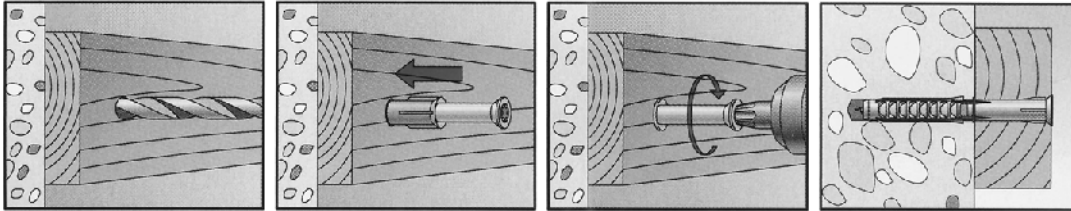

Type	☒	Art.number	Type	☒	Art.number	Type	☒	Art.number
SXS 10X80T	50	<a href="#">63298.100.080</a>	SXS 10X140T	50	<a href="#">63298.100.140</a>	SXS 10X160T	50	<a href="#">63298.100.160</a>
SXS 10X100T	50	<a href="#">63298.100.100</a>						

- With pre-assembled steel zinc plated countersunk head screw with hexalobular.