

## Expansion anchor with brass cone

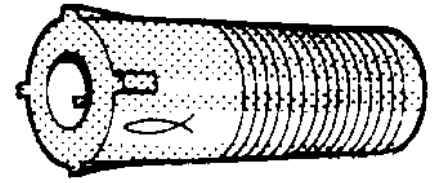
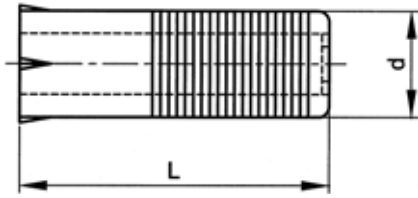

### Technical data

Type	M5	M6	M8	M10	M12	M16
d	10	12	16	20	24	32
L	35	40	50	60	70	90
Drill $\phi$	10	12	16	20	24	32
Drill depth (min.)	45	50	65	80	90	120
Pull-out force in kN	-					
Concrete $\geq$ C20/25	5,5	9	13	22	25	43

- Pull-out force in kN.
- It is advised to take a safety factor  $\geq$  7.

### Assembly sequence

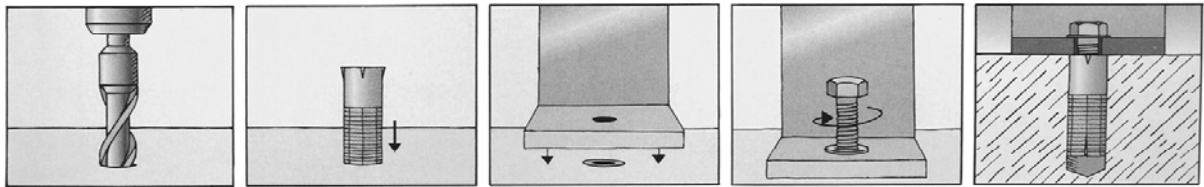

63400 FISCHER Expansion anchor with brass cone type M

N03B

Thread Metric thread  
Material Glass-fibre reinforced plastic  
Packaging Standard

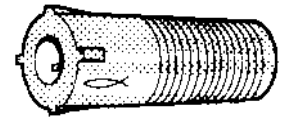

Type	☒	Art.number	Type	☒	Art.number	Type	☒	Art.number
M5	50	<a href="#">63400.050.001</a>	M8	20	<a href="#">63400.080.001</a>	M12	5	<a href="#">63400.120.001</a>
M6	50	<a href="#">63400.060.001</a>	M10	10	<a href="#">63400.100.001</a>			

## Anchor

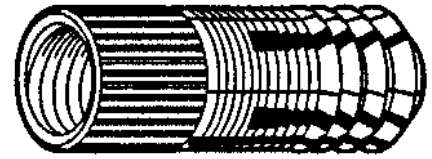
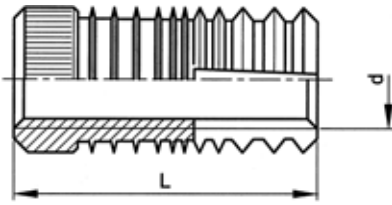

### Technical data

Type	PA 4 M6/7,5	PA 4 M6/13,5	PA 4 M8/25	PA 4 M10/25
d	M6	M6	M8	M10
P	1	1	1,25	1,5
L	7,5	13,5	25	25
Drill ø	8	8	10	12
Drill depth (min.)	7,5	13,5	25	25
Drill ø in construction	7,5	7,5	9,5	11,5
Assembly depth (min.)	7,5	13,5	25	25
<b>Pull-out force in kN</b>				
Chipboard	0,8	1,6	-	-
Pine wood	0,7	1,5	-	-
Beech wood	2	4	-	-
Plastic	3	8	-	-
Brick Mz12	-	3,2	7,8	9,2

- Length of screw min. = length of plug + thickness of fixing part.
- It is advised to take a safety factor:  $\geq 4$ .

### Assembly sequence

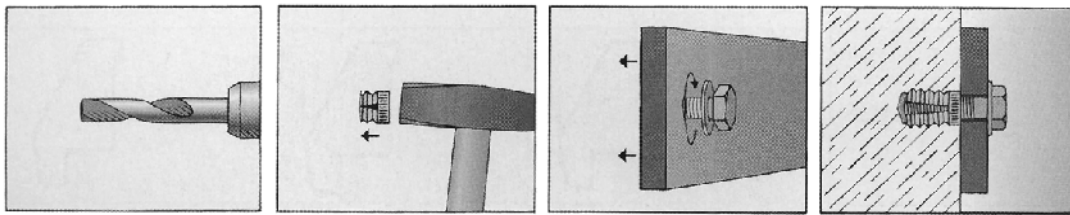

### 63410 FISCHER Anchor type PA

N03A

Thread: Metric thread  
Material: Brass  
Packaging: Standard

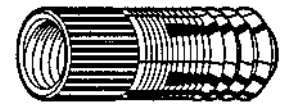

Type	☒	Art.number	Type	☒	Art.number	Type	☒	Art.number
PA4 M6X7,5	200	<a href="#">63410.060.007</a>	PA4 M8X25	50	<a href="#">63410.080.025</a>			
PA4 M6X13,5	100	<a href="#">63410.060.013</a>	PA4 M10X25	25	<a href="#">63410.100.025</a>			

## Female threaded hammer-in anchor SA

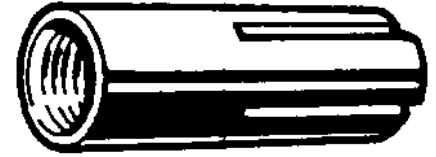
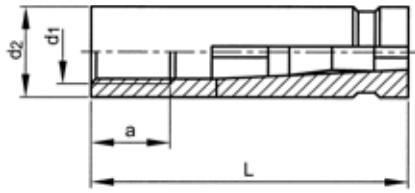

### Technical data

	M6	M8	M10	M12	M16
d1	M6	M8	M10	M12	M16
L	30	30	40	50	65
d <sub>2</sub>	8	10	12	15	20
a	13	13	15	18	23
Drill ø	8	10	12	15	20
Drill depth (min.)	32	32	42	53	70
Tightening torque in Nm	4	8	15	35	60
Allowable load in kN					
Concrete ≥ C20/25	1	1,8	3,6	5,7	7,4

- Female threaded hammer-in anchor type GRIP SA can be installed with setting tool type S (see article group 70967).

### Assembly sequence

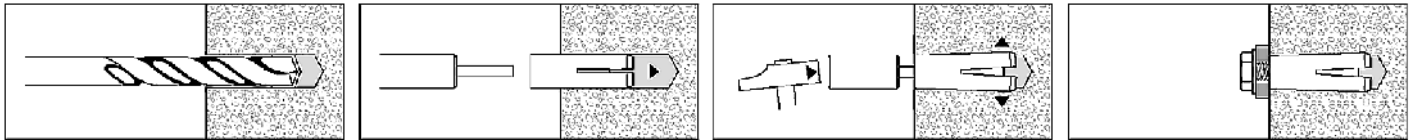

### 70875 SPIT Female threaded hammer-in anchor type SA

P03B

Thread Metric thread  
Material Stainless steel A4  
Packaging Standard

**spit**

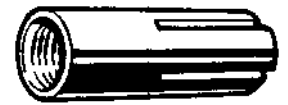

d1	☒	Art.number	d1	☒	Art.number	d1	☒	Art.number
M6	100	<a href="#">70875.060.001</a>	M10	50	<a href="#">70875.100.001</a>	M16	25	<a href="#">70875.160.001</a>
M8	100	<a href="#">70875.080.001</a>	M12	50	<a href="#">70875.120.001</a>			

**Setting tool SA**

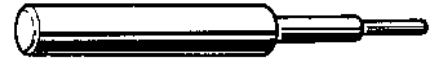

<b>70967</b>	<b>SPIT Setting tool</b>	<b>P03C</b>
<b>Material</b>	Steel	 
<b>Packaging</b>	Standard	

Type	☒	Art.number	Type	☒	Art.number	Type	☒	Art.number
S 6	1	<a href="#">70967.000.006</a>	S 10	1	<a href="#">70967.000.010</a>			
S 8	1	<a href="#">70967.000.008</a>	S 12	1	<a href="#">70967.000.012</a>			

## Hammerset anchor EA II

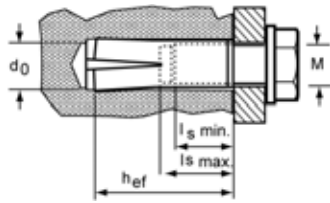

### Technical data

Type	EA II M6	EA II M8	EA II M10	EA II M12	EA II M16	EA II M20
d	M6	M8	M10	M12	M16	M20
L	30	30	40	50	65	80
d <sub>0</sub>	8	10	12	15	20	25
t	32	33	43	54	70	85
h <sub>ef</sub>	30	30	40	50	65	80
l <sub>s min.</sub>	6	8	10	12	16	20
l <sub>s max.</sub>	13	13	17	22	28	34
k <sub>N</sub>	3,9	3,9	6,1	8,5	12,6	17,2

- d<sub>0</sub> = Nominal diameter of drill bit.
- t = Recommended drilling depth.
- h<sub>ef</sub> = Effective anchorage depth.
- l<sub>s min.</sub> = Screw-in depth min.
- l<sub>s max.</sub> = Screw-in depth max.
- k<sub>N</sub> = Load in kN in combination with 8.8 bolts.
- The cone must be installed with setting tool type EAW H (narrow end) into the anchor body (article group 63322).
- Only part of the approval for light suspended ceilings.
- For further technical data the approval is available on request.

### Assembly sequence

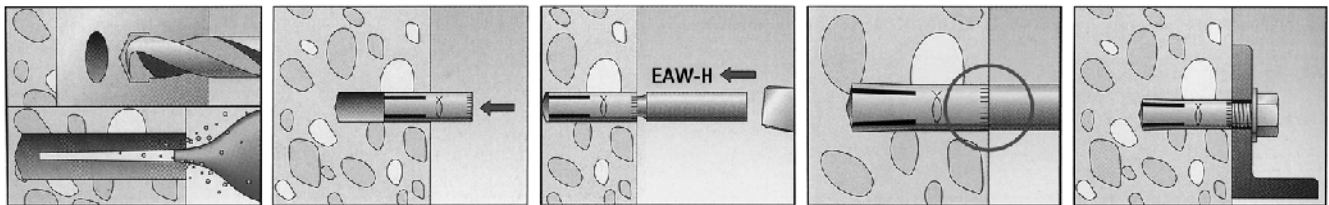

### Article groups

Thread	Material	Surface treatment	Packaging	Code	Page
M	St	Zipl	Standard	63320	8-48
M	St.St. A4		Standard	63321	8-49

8

63320 FISCHER Hammerset anchor type EA II		N03A
Thread	Metric thread	
Material	Steel	
Surface treatment	Zinc plated	
Packaging	Standard	



Final calculations should comply with the complete European Technical Approval (ETA), this approval is also available on request.

Type	☒	Art.number	Type	☒	Art.number	Type	☒	Art.number
EA II M6 (EV)	100	<a href="#">63320.060.001</a>	EA II M8 (EV)	100	<a href="#">63320.080.001</a>	EA II M10 (EV)	50	<a href="#">63320.100.001</a>

63320 FISCHER Hammerset anchor type EA II								
Type	☒	Art.number	Type	☒	Art.number	Type	☒	Art.number
EA II M12 (EV)	25	<a href="#">63320.120.001</a>	EA II M16 (EV)	20	<a href="#">63320.160.001</a>			
EA II M12 D (EV)	25	<a href="#">63320.120.005</a>	EA II M20 (EV)	10	<a href="#">63320.200.001</a>			

63321 FISCHER Hammerset anchor type EA II		N03A
Thread	Metric thread	
Material	Stainless steel A4	
Packaging	Standard	
		 



Final calculations should comply with the complete European Technical Approval (ETA), this approval is also available on request.

Type	☒	Art.number	Type	☒	Art.number	Type	☒	Art.number
EA II M6 A4	100	<a href="#">63321.060.001</a>	EA II M10 A4	50	<a href="#">63321.100.001</a>	EA II M16 A4	20	<a href="#">63321.160.001</a>
EA II M8 A4	100	<a href="#">63321.080.001</a>	EA II M12 A4	25	<a href="#">63321.120.001</a>			

**Setting tool for EA II**

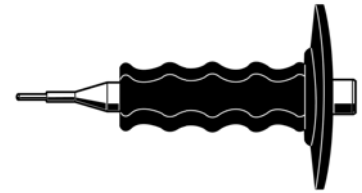

<b>63322 Setting tool for EA II</b>		<b>N03A</b>
<b>Material</b>	Steel	
<b>Surface treatment</b>	Zinc plated	
<b>Packaging</b>	Standard	
		

Type	☒	Art.number	Type	☒	Art.number	Type	☒	Art.number
EAW H 6 PLUS	1	<a href="#">63322.060.001</a>	EAW H 10 PLUS	1	<a href="#">63322.100.001</a>	EAW H 16 PLUS	1	<a href="#">63322.160.001</a>
EAW H 8 PLUS	1	<a href="#">63322.080.001</a>	EAW H 12 PLUS	1	<a href="#">63322.120.001</a>	EAW H 20 PLUS	1	<a href="#">63322.200.001</a>

## Hollow-ceiling anchor type FHY

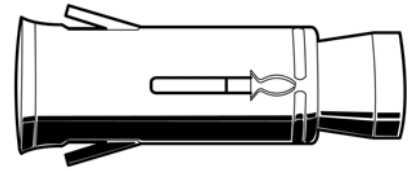
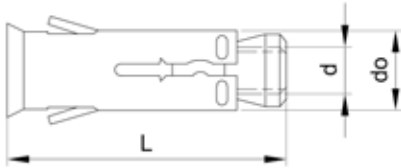

### Technical data

Type / d	FHY M6	FHY M8	FHY M10
$d_o$	10	12	16
L	37	43	52
Min. $t_d$	50	60	65
$h_{ef}$	30	35	40
Structural part thickness (min.)	40mm	40mm	40mm
Allowable load in kN			
Concrete $\geq$ C50/60	1,8	1,8	2,7

- $d_o$  = Nominal diameter of drill bit
- Min.  $t_d$  = Recommended drilling depth
- $h_{ef}$  = Effective anchorage depth

### Assembly sequence

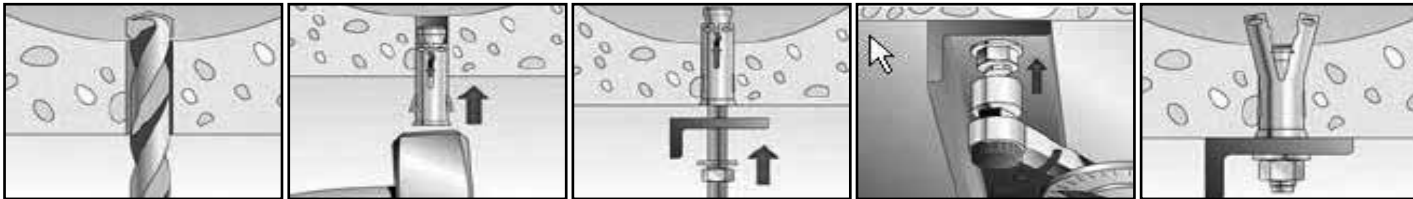

### 63428 FISCHER Hollow-ceiling anchor type FHY

N03A

Thread: Metric thread  
 Material: Steel  
 Surface treatment: Zinc plated  
 Packaging: Standard

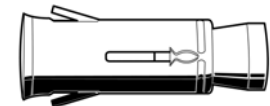

Type / d	☒	Art.number	Type / d	☒	Art.number	Type / d	☒	Art.number
FHY M6	50	<a href="#">63428.060.001</a>	FHY M8	25	<a href="#">63428.080.001</a>	FHY M10	20	<a href="#">63428.100.001</a>