

## Adjusting ring with set screw

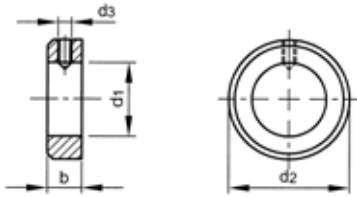

ISO - / 7434  
**DIN 705 A**  
 NEN - / 1488  
 NF - / E25-161  
 BS - / 4219

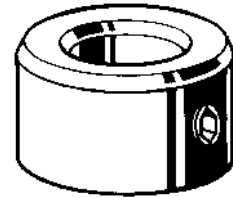

### Technical data

d1 (H8)	d2 (h13)	b (js14)	d3
3	7	5	M2
4	8	5	M2,5
5	10	6	M3
6	12	8	M4
7	12	8	M4
8	16	8	M4
9 (#DIN)	18	10	M5
10	20	10	M5
11 (#DIN)	20	10	M5
12	22	12	M6
13 (#DIN)	22	12	M6
14	25	12	M6
15	25	12	M6
16	28	12	M6
18	32	14	M6
20	32	14	M6
22	36	14	M6
24	40	16	M8
25	40	16	M8
26	40	16	M8
28	45	16	M8
30	45	16	M8
32	50	16	M8
34 (#DIN)	50	16	M8
35	56	16	M8
36	56	16	M8
38 (#DIN)	56	16	M8
40	63	18	M10
42 (#DIN)	63	18	M10
45	70	18	M10
48 (#DIN)	70	18	M10
50	80	18	M10
55	80	18	M10
56	80	18	M10
58 (#DIN)	90	20	M10
60	90	20	M10
63	90	20	M10
65	100	20	M10
70	100	20	M10
75 (2xset)	110	22	M12
80 (2xset)	110	22	M12

### Article groups

Material	Surface treatment		Packaging	Code	Page
Free-cutting steel		with DIN 916	Standard	37810	7-123
Free-cutting steel		with DIN 553	Standard	37815	7-123
Free-cutting steel	Zipl	with DIN 916	Standard	37820	7-123
St.St. A1		with DIN 916	Standard	51370	7-123
St.St. A1		with DIN 553	Standard	51372	7-124

**37810 Adjusting ring with hexagon socket set screw** L07F

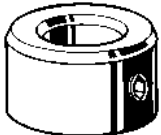
<b>Material</b>	Free-cutting steel	
<b>Packaging</b>	Standard	
	ISO - / 4029	
	<b>DIN 705 A / 916</b>	
	NEN - / 2343	
	NF - / E27-183 BS - / 4168-5	

d1 x d2 x b	☒	Art.number	d1 x d2 x b	☒	Art.number	d1 x d2 x b	☒	Art.number
3X7X5MM	50	<a href="#">37810.030.001</a>	18X32X14MM	10	<a href="#">37810.180.001</a>	42X63X18MM	5	<a href="#">37810.420.001</a>
4X8X5MM	50	<a href="#">37810.040.001</a>	20X32X14MM	10	<a href="#">37810.200.001</a>	45X70X18MM	5	<a href="#">37810.450.001</a>
5X10X6MM	50	<a href="#">37810.050.001</a>	22X36X14MM	10	<a href="#">37810.220.001</a>	48X70X18MM	5	<a href="#">37810.480.001</a>
6X12X8MM	50	<a href="#">37810.060.001</a>	24X40X16MM	10	<a href="#">37810.240.001</a>	50X80X18MM	5	<a href="#">37810.500.001</a>
7X12X8MM	50	<a href="#">37810.070.001</a>	25X40X16MM	10	<a href="#">37810.250.001</a>	55X80X18MM	1	<a href="#">37810.550.001</a>
8X16X8MM	50	<a href="#">37810.080.001</a>	26X40X16MM	10	<a href="#">37810.260.001</a>	56X80X18MM	1	<a href="#">37810.560.001</a>
9X18X10MM	25	<a href="#">37810.090.001</a>	28X45X16MM	10	<a href="#">37810.280.001</a>	58X90X20MM	1	<a href="#">37810.580.001</a>
10X20X10MM	25	<a href="#">37810.100.001</a>	30X45X16MM	10	<a href="#">37810.300.001</a>	60X90X20MM	1	<a href="#">37810.600.001</a>
11X20X10MM	25	<a href="#">37810.110.001</a>	32X50X16MM	10	<a href="#">37810.320.001</a>	63X90X20MM	1	<a href="#">37810.630.001</a>
12X22X12MM	10	<a href="#">37810.120.001</a>	34X50X16MM	5	<a href="#">37810.340.001</a>	65X100X20MM	1	<a href="#">37810.650.001</a>
13X22X12MM	10	<a href="#">37810.130.001</a>	35X56X16MM	5	<a href="#">37810.350.001</a>	70X100X20MM	1	<a href="#">37810.700.001</a>
14X25X12MM	10	<a href="#">37810.140.001</a>	36X56X16MM	5	<a href="#">37810.360.001</a>	75X110X22MM	1	<a href="#">37810.750.001</a>
15X25X12MM	10	<a href="#">37810.150.001</a>	38X56X16MM	5	<a href="#">37810.380.001</a>	80X110X22MM	1	<a href="#">37810.800.001</a>
16X28X12MM	10	<a href="#">37810.160.001</a>	40X63X18MM	5	<a href="#">37810.400.001</a>			

**37815 Adjusting ring with slotted set screw** L07F

<b>Material</b>	Free-cutting steel	
<b>Packaging</b>	Standard	
	DIN 705 A / 553	

d1 x d2 x b	☒	Art.number	d1 x d2 x b	☒	Art.number	d1 x d2 x b	☒	Art.number
3X7X5MM	50	<a href="#">37815.030.001</a>	18X32X14MM	10	<a href="#">37815.180.001</a>	40X63X18MM	5	<a href="#">37815.400.001</a>
4X8X5MM	50	<a href="#">37815.040.001</a>	20X32X14MM	10	<a href="#">37815.200.001</a>	42X63X18MM	5	<a href="#">37815.420.001</a>
5X10X6MM	50	<a href="#">37815.050.001</a>	22X36X14MM	10	<a href="#">37815.220.001</a>	45X70X18MM	5	<a href="#">37815.450.001</a>
6X12X8MM	50	<a href="#">37815.060.001</a>	24X40X16MM	10	<a href="#">37815.240.001</a>	48X70X18MM	5	<a href="#">37815.480.001</a>
7X12X8MM	50	<a href="#">37815.070.001</a>	25X40X16MM	10	<a href="#">37815.250.001</a>	50X80X18MM	5	<a href="#">37815.500.001</a>
8X16X8MM	50	<a href="#">37815.080.001</a>	26X40X16MM	10	<a href="#">37815.260.001</a>	55X80X18MM	1	<a href="#">37815.550.001</a>
9X18X10MM	25	<a href="#">37815.090.001</a>	28X45X16MM	10	<a href="#">37815.280.001</a>	58X90X20MM	1	<a href="#">37815.580.001</a>
10X20X10MM	25	<a href="#">37815.100.001</a>	30X45X16MM	10	<a href="#">37815.300.001</a>	60X90X20MM	1	<a href="#">37815.600.001</a>
11X20X10MM	25	<a href="#">37815.110.001</a>	32X50X16MM	10	<a href="#">37815.320.001</a>	63X90X20MM	1	<a href="#">37815.630.001</a>
12X22X12MM	10	<a href="#">37815.120.001</a>	34X50X16MM	5	<a href="#">37815.340.001</a>	65X100X20MM	1	<a href="#">37815.650.001</a>
14X25X12MM	10	<a href="#">37815.140.001</a>	35X56X16MM	5	<a href="#">37815.350.001</a>	70X100X20MM	1	<a href="#">37815.700.001</a>
15X25X12MM	10	<a href="#">37815.150.001</a>	36X56X16MM	5	<a href="#">37815.360.001</a>	75X110X22MM	1	<a href="#">37815.750.001</a>
16X28X12MM	10	<a href="#">37815.160.001</a>	38X56X16MM	5	<a href="#">37815.380.001</a>	80X110X22MM	1	<a href="#">37815.800.001</a>

**37820 Adjusting ring with hexagon socket set screw** L07F

<b>Material</b>	Free-cutting steel	
<b>Surface treatment</b>	Zinc plated	
<b>Packaging</b>	Standard	
	ISO - / 4029	
	<b>DIN 705 A / 916</b>	
	NEN - / 2343 NF - / E27-183 BS - / 4168-5	

d1 x d2 x b	☒	Art.number	d1 x d2 x b	☒	Art.number	d1 x d2 x b	☒	Art.number
5X10X6MM	50	<a href="#">37820.050.001</a>	16X28X12MM	10	<a href="#">37820.160.001</a>	30X45X16MM	10	<a href="#">37820.300.001</a>
6X12X8MM	50	<a href="#">37820.060.001</a>	18X32X14MM	10	<a href="#">37820.180.001</a>	35X56X16MM	5	<a href="#">37820.350.001</a>
8X16X8MM	50	<a href="#">37820.080.001</a>	20X32X14MM	10	<a href="#">37820.200.001</a>	40X63X18MM	5	<a href="#">37820.400.001</a>
10X20X10MM	25	<a href="#">37820.100.001</a>	22X36X14MM	10	<a href="#">37820.220.001</a>	45X70X18MM	5	<a href="#">37820.450.001</a>
12X22X12MM	10	<a href="#">37820.120.001</a>	25X40X16MM	10	<a href="#">37820.250.001</a>	50X80X18MM	5	<a href="#">37820.500.001</a>
14X25X12MM	10	<a href="#">37820.140.001</a>	26X40X16MM	10	<a href="#">37820.260.001</a>	60X90X20MM	1	<a href="#">37820.600.001</a>
15X25X12MM	10	<a href="#">37820.150.001</a>	28X45X16MM	10	<a href="#">37820.280.001</a>	70X100X20MM	1	<a href="#">37820.700.001</a>

**51370 Adjusting ring with hexagon socket set screw** R09A

<b>Material</b>	Stainless steel A1	
<b>Packaging</b>	Standard	
	ISO - / 4029	
	<b>DIN 705 A / 916</b>	
	NEN - / 2343	
	NF - / E27-183 BS - / 4168-5	

d1 x d2 x b	☒	Art.number	d1 x d2 x b	☒	Art.number	d1 x d2 x b	☒	Art.number
5X10X6MM	25	<a href="#">51370.050.001</a>	14X25X12MM	10	<a href="#">51370.140.001</a>	22X36X14MM	5	<a href="#">51370.220.001</a>
6X12X8MM	25	<a href="#">51370.060.001</a>	15X25X12MM	10	<a href="#">51370.150.001</a>	25X40X16MM	5	<a href="#">51370.250.001</a>
8X16X8MM	25	<a href="#">51370.080.001</a>	16X28X12MM	5	<a href="#">51370.160.001</a>	28X45X16MM	2	<a href="#">51370.280.001</a>
10X20X10MM	10	<a href="#">51370.100.001</a>	18X32X14MM	5	<a href="#">51370.180.001</a>	30X45X16MM	2	<a href="#">51370.300.001</a>
12X22X12MM	10	<a href="#">51370.120.001</a>	20X32X14MM	5	<a href="#">51370.200.001</a>	35X56X16MM	2	<a href="#">51370.350.001</a>

**51370 Adjusting ring with hexagon socket set screw**

d1 x d2 x b	☒	Art.number	d1 x d2 x b	☒	Art.number	d1 x d2 x b	☒	Art.number
36X56X16MM	1	<a href="#">51370.360.001</a>	45X70X18MM	1	<a href="#">51370.450.001</a>	60X90X20MM	1	<a href="#">51370.600.001</a>
40X63X18MM	1	<a href="#">51370.400.001</a>	50X80X18MM	1	<a href="#">51370.500.001</a>			

**51372 Adjusting ring with slotted set screw**
**R09A**

**Material** Stainless steel A1  
**Packaging** Standard  
**DIN** ≈705 A / 553

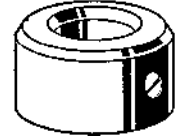

d1 x d2 x b	☒	Art.number	d1 x d2 x b	☒	Art.number	d1 x d2 x b	☒	Art.number
5X10X6MM	25	<a href="#">51372.050.001</a>	16X28X12MM	5	<a href="#">51372.160.001</a>	34X50X16MM	2	<a href="#">51372.340.001</a>
6X12X8MM	25	<a href="#">51372.060.001</a>	20X32X14MM	5	<a href="#">51372.200.001</a>	35X56X16MM	2	<a href="#">51372.350.001</a>
8X16X8MM	25	<a href="#">51372.080.001</a>	24X40X16MM	5	<a href="#">51372.240.001</a>	36X56X16MM	1	<a href="#">51372.360.001</a>
9X18X10MM	10	<a href="#">51372.090.001</a>	25X40X16MM	5	<a href="#">51372.250.001</a>	38X56X16MM	1	<a href="#">51372.380.001</a>
10X20X10MM	10	<a href="#">51372.100.001</a>	26X40X16MM	5	<a href="#">51372.260.001</a>	40X63X18MM	1	<a href="#">51372.400.001</a>
11X20X10MM	10	<a href="#">51372.110.001</a>	28X45X16MM	2	<a href="#">51372.280.001</a>	45X70X18MM	1	<a href="#">51372.450.001</a>
12X22X12MM	10	<a href="#">51372.120.001</a>	30X45X16MM	2	<a href="#">51372.300.001</a>	50X80X18MM	1	<a href="#">51372.500.001</a>
15X25X12MM	10	<a href="#">51372.150.001</a>	32X50X16MM	2	<a href="#">51372.320.001</a>			