

Round head rivet

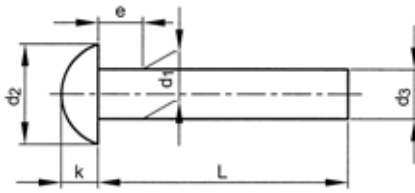

ISO 1051
 DIN 660/124
 BS 4620

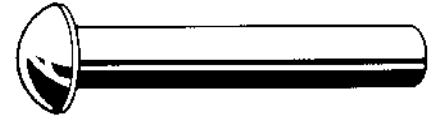

Technical data

d1	d2	d3 (min.)	e (max.)	k (js14)
2	3,5	1,87	1	1,2
2,5	4,4	2,37	1,25	1,5
3	5,2	2,87	1,5	1,8
4	7	3,87	2	2,4
5	8,8	4,82	2,5	3
6	10,5	5,82	3	3,6
8	14	7,76	4	4,8
10 (DIN124)	16	9,4	5	6,5

Article groups

Material	Packaging	Code	Page
St DIN1654-2	Standard	39400	9-30
St.St. A2	Standard	51490	9-30
Al 99,5 DIN1790-1	Standard	50670	9-31
Cu	Standard	50370	9-31

39400 Round head rivet

L11C

Material Steel DIN1654-2
Packaging Standard

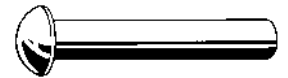

d1 x L	☒	Art.number	d1 x L	☒	Art.number	d1 x L	☒	Art.number
2X6MM	1000	39400.020.006	4X30MM	500	39400.040.030	6X60MM	100	39400.060.060
2X8MM	1000	39400.020.008	4X40MM	250	39400.040.040			
2X10MM	1000	39400.020.010				8X10MM	250	39400.080.010
2X12MM	1000	39400.020.012	5X8MM	1000	39400.050.008	8X12MM	250	39400.080.012
2X16MM	1000	39400.020.016	5X10MM	1000	39400.050.010	8X16MM	250	39400.080.016
			5X12MM	1000	39400.050.012	8X20MM	250	39400.080.020
3X6MM	1000	39400.030.006	5X16MM	1000	39400.050.016	8X25MM	250	39400.080.025
3X8MM	1000	39400.030.008	5X20MM	500	39400.050.020	8X30MM	250	39400.080.030
3X10MM	1000	39400.030.010	5X25MM	500	39400.050.025	8X35MM	100	39400.080.035
3X12MM	1000	39400.030.012	5X30MM	500	39400.050.030	8X40MM	100	39400.080.040
3X16MM	1000	39400.030.016	5X40MM	250	39400.050.040	8X50MM	100	39400.080.050
3X20MM	1000	39400.030.020	5X50MM	250	39400.050.050	8X60MM	100	39400.080.060
3X25MM	1000	39400.030.025						
3X30MM	1000	39400.030.030	6X10MM	500	39400.060.010	10X20MM	100	39400.100.020
			6X12MM	500	39400.060.012	10X25MM	100	39400.100.025
4X6MM	1000	39400.040.006	6X16MM	500	39400.060.016	10X30MM	100	39400.100.030
4X8MM	1000	39400.040.008	6X20MM	500	39400.060.020	10X35MM	100	39400.100.035
4X10MM	1000	39400.040.010	6X25MM	250	39400.060.025	10X40MM	100	39400.100.040
4X12MM	1000	39400.040.012	6X30MM	250	39400.060.030	10X50MM	100	39400.100.050
4X16MM	1000	39400.040.016	6X35MM	250	39400.060.035			
4X20MM	1000	39400.040.020	6X40MM	250	39400.060.040			
4X25MM	500	39400.040.025	6X50MM	250	39400.060.050			

51490 Round head rivet

R09A

Material Stainless steel A2
Packaging Standard

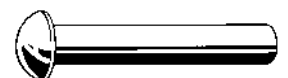

d1 x L	☒	Art.number	d1 x L	☒	Art.number	d1 x L	☒	Art.number
3X6MM	200	51490.030.006	3X20MM	200	51490.030.020	4X16MM	100	51490.040.016
3X8MM	200	51490.030.008				4X20MM	100	51490.040.020
3X10MM	200	51490.030.010	4X8MM	200	51490.040.008	4X25MM	100	51490.040.025
3X12MM	200	51490.030.012	4X10MM	200	51490.040.010	4X30MM	100	51490.040.030
3X16MM	200	51490.030.016	4X12MM	200	51490.040.012	4X40MM	100	51490.040.040

51490 Round head rivet

d1 x L	☒	Art.number	d1 x L	☒	Art.number	d1 x L	☒	Art.number
4X50MM	100	51490.040.050	5X20MM	100	51490.050.020	6X20MM	100	51490.060.020
4X60MM	100	51490.040.060	5X25MM	100	51490.050.025	6X25MM	100	51490.060.025
			5X30MM	100	51490.050.030	6X30MM	100	51490.060.030
5X8MM	100	51490.050.008				6X35MM	100	51490.060.035
5X10MM	100	51490.050.010	6X10MM	100	51490.060.010			
5X12MM	100	51490.050.012	6X12MM	100	51490.060.012			
5X16MM	100	51490.050.016	6X16MM	100	51490.060.016			

50670 Round head rivet W01A

Material	Aluminium 99,5 DIN1790-1
Packaging	Standard



d1 x L	☒	Art.number	d1 x L	☒	Art.number	d1 x L	☒	Art.number
2X4MM	1000	50670.020.004	4X8MM	1000	50670.040.008	6X12MM	500	50670.060.012
2X6MM	1000	50670.020.006	4X10MM	1000	50670.040.010	6X16MM	500	50670.060.016
2X8MM	1000	50670.020.008	4X12MM	1000	50670.040.012	6X20MM	500	50670.060.020
2X10MM	1000	50670.020.010	4X16MM	1000	50670.040.016	6X25MM	250	50670.060.025
2X12MM	1000	50670.020.012	4X20MM	1000	50670.040.020	6X30MM	250	50670.060.030
2X16MM	1000	50670.020.016	4X25MM	500	50670.040.025	6X35MM	250	50670.060.035
			4X30MM	500	50670.040.030	6X40MM	250	50670.060.040
3X4MM	1000	50670.030.004	4X40MM	250	50670.040.040	6X50MM	250	50670.060.050
3X6MM	1000	50670.030.006						
3X7MM	1000	50670.030.007	5X8MM	1000	50670.050.008	8X16MM	250	50670.080.016
3X8MM	1000	50670.030.008	5X10MM	1000	50670.050.010	8X20MM	250	50670.080.020
3X10MM	1000	50670.030.010	5X12MM	1000	50670.050.012	8X25MM	250	50670.080.025
3X12MM	1000	50670.030.012	5X16MM	1000	50670.050.016	8X30MM	250	50670.080.030
3X16MM	1000	50670.030.016	5X20MM	500	50670.050.020	8X35MM	100	50670.080.035
3X20MM	1000	50670.030.020	5X25MM	500	50670.050.025	8X40MM	100	50670.080.040
3X25MM	1000	50670.030.025	5X30MM	500	50670.050.030			
3X30MM	1000	50670.030.030	5X40MM	250	50670.050.040			
4X6MM	1000	50670.040.006	6X10MM	500	50670.060.010			

50370 Round head rivet M11F

Material	Copper
Packaging	Standard

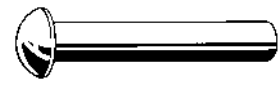

d1 x L	☒	Art.number	d1 x L	☒	Art.number	d1 x L	☒	Art.number
2X4MM	1000	50370.020.004	4X6MM	1000	50370.040.006	6X12MM	500	50370.060.012
2X6MM	1000	50370.020.006	4X8MM	1000	50370.040.008	6X16MM	500	50370.060.016
2X8MM	1000	50370.020.008	4X10MM	1000	50370.040.010	6X20MM	500	50370.060.020
2X10MM	1000	50370.020.010	4X12MM	1000	50370.040.012	6X25MM	250	50370.060.025
2X12MM	1000	50370.020.012	4X16MM	1000	50370.040.016	6X30MM	250	50370.060.030
2X16MM	1000	50370.020.016	4X20MM	1000	50370.040.020	6X35MM	250	50370.060.035
			4X25MM	500	50370.040.025	6X40MM	250	50370.060.040
2,5X6MM	1000	50370.025.006	4X30MM	500	50370.040.030	6X50MM	250	50370.060.050
2,5X8MM	1000	50370.025.008	4X40MM	250	50370.040.040			
2,5X10MM	1000	50370.025.010						
3X4MM	1000	50370.030.004	5X8MM	1000	50370.050.008	8X16MM	250	50370.080.016
3X6MM	1000	50370.030.006	5X10MM	1000	50370.050.010	8X20MM	250	50370.080.020
3X8MM	1000	50370.030.008	5X12MM	1000	50370.050.012	8X25MM	250	50370.080.025
3X10MM	1000	50370.030.010	5X16MM	1000	50370.050.016	8X30MM	250	50370.080.030
3X12MM	1000	50370.030.012	5X20MM	500	50370.050.020	8X40MM	100	50370.080.040
3X16MM	1000	50370.030.016	5X25MM	500	50370.050.025	8X50MM	100	50370.080.050
3X20MM	1000	50370.030.020	5X30MM	500	50370.050.030			
3X25MM	1000	50370.030.025	5X40MM	250	50370.050.040	10X30MM	100	50370.100.030
3X30MM	1000	50370.030.030	5X50MM	250	50370.050.050	10X40MM	100	50370.100.040
			6X10MM	500	50370.060.010	10X50MM	100	50370.100.050

Countersunk head rivet

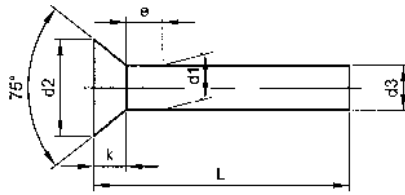

ISO 1051
 DIN 661
 BS 4620

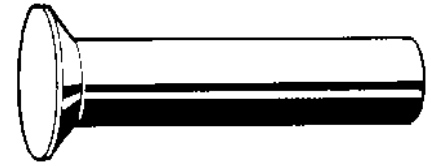

Technical data

d1	d2	d3 (min.)	e (max.)	k ≈
2	3,5	1,87	1	1
2,5	4,4	2,37	1,25	1,2
3	5,2	2,87	1,5	1,4
4	7	3,87	2	2
5	8,8	4,82	2,5	2,5
6	10,5	5,82	3	3
8	14	7,76	4	4
10 (DIN302)	14,5	9,4	5	3

Article groups

Material	Packaging	Code	Page
St DIN1654-2	Standard	39410	9-32
St.St. A2	Standard	51480	9-32
Al 99,5 DIN1790-1	Standard	50680	9-33
Cu	Standard	50380	9-33

39410 Countersunk head rivet

L11C

Material Steel DIN1654-2
Packaging Standard

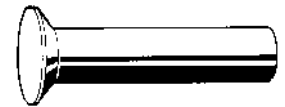

d1 x L	☒	Art.number	d1 x L	☒	Art.number	d1 x L	☒	Art.number
2X6MM	1000	39410.020.006	4X16MM	1000	39410.040.016	6X25MM	250	39410.060.025
2X8MM	1000	39410.020.008	4X20MM	1000	39410.040.020	6X30MM	250	39410.060.030
2X10MM	1000	39410.020.010	4X25MM	500	39410.040.025	6X35MM	250	39410.060.035
2X12MM	1000	39410.020.012	4X30MM	500	39410.040.030	6X40MM	250	39410.060.040
2X16MM	1000	39410.020.016				6X50MM	250	39410.060.050
			5X8MM	1000	39410.050.008			
3X6MM	1000	39410.030.006	5X10MM	1000	39410.050.010	8X16MM	250	39410.080.016
3X8MM	1000	39410.030.008	5X12MM	1000	39410.050.012	8X20MM	250	39410.080.020
3X10MM	1000	39410.030.010	5X16MM	1000	39410.050.016	8X25MM	250	39410.080.025
3X12MM	1000	39410.030.012	5X20MM	500	39410.050.020	8X30MM	250	39410.080.030
3X16MM	1000	39410.030.016	5X25MM	500	39410.050.025	8X35MM	100	39410.080.035
3X20MM	1000	39410.030.020	5X30MM	500	39410.050.030	8X40MM	100	39410.080.040
3X25MM	1000	39410.030.025	5X40MM	250	39410.050.040	8X50MM	100	39410.080.050
3X30MM	1000	39410.030.030	5X50MM	250	39410.050.050	8X60MM	100	39410.080.060
4X6MM	1000	39410.040.006	6X10MM	500	39410.060.010	10X30MM	100	39410.100.030
4X8MM	1000	39410.040.008	6X12MM	500	39410.060.012	10X40MM	100	39410.100.040
4X10MM	1000	39410.040.010	6X16MM	500	39410.060.016	10X50MM	100	39410.100.050
4X12MM	1000	39410.040.012	6X20MM	500	39410.060.020			

9

51480 Countersunk head rivet

R09A

Material Stainless steel A2
Packaging Standard

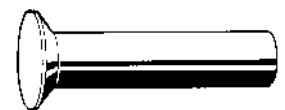

d1 x L	☒	Art.number	d1 x L	☒	Art.number	d1 x L	☒	Art.number
3X6MM	200	51480.030.006	4X10MM	200	51480.040.010	5X8MM	100	51480.050.008
3X8MM	200	51480.030.008	4X12MM	200	51480.040.012	5X10MM	100	51480.050.010
3X10MM	200	51480.030.010	4X16MM	100	51480.040.016	5X12MM	100	51480.050.012
3X12MM	200	51480.030.012	4X20MM	100	51480.040.020	5X16MM	100	51480.050.016
3X16MM	200	51480.030.016	4X25MM	100	51480.040.025	5X20MM	100	51480.050.020
			4X30MM	100	51480.040.030	5X25MM	100	51480.050.025
						5X30MM	100	51480.050.030

51480 Countersunk head rivet ←

d1 x L	☒	Art.number	d1 x L	☒	Art.number	d1 x L	☒	Art.number
6X10MM	100	51480.060.010	6X16MM	100	51480.060.016	6X30MM	100	51480.060.030
6X12MM	100	51480.060.012	6X20MM	100	51480.060.020			
			6X25MM	100	51480.060.025			

50680 Countersunk head rivet W01A

Material Aluminium 99,5 DIN1790-1
Packaging Standard

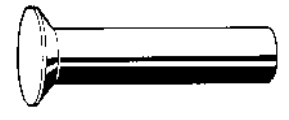

d1 x L	☒	Art.number	d1 x L	☒	Art.number	d1 x L	☒	Art.number
2X6MM	1000	50680.020.006	4X10MM	1000	50680.040.010	6X12MM	500	50680.060.012
2X8MM	1000	50680.020.008	4X12MM	1000	50680.040.012	6X16MM	500	50680.060.016
2X10MM	1000	50680.020.010	4X16MM	1000	50680.040.016	6X20MM	500	50680.060.020
2X12MM	1000	50680.020.012	4X20MM	1000	50680.040.020	6X25MM	250	50680.060.025
2X16MM	1000	50680.020.016	4X25MM	500	50680.040.025	6X30MM	250	50680.060.030
			4X30MM	500	50680.040.030	6X35MM	250	50680.060.035
3X6MM	1000	50680.030.006				6X40MM	250	50680.060.040
3X8MM	1000	50680.030.008	5X8MM	1000	50680.050.008	6X50MM	250	50680.060.050
3X10MM	1000	50680.030.010	5X10MM	1000	50680.050.010			
3X12MM	1000	50680.030.012	5X12MM	1000	50680.050.012	8X16MM	250	50680.080.016
3X16MM	1000	50680.030.016	5X16MM	1000	50680.050.016	8X20MM	250	50680.080.020
3X20MM	1000	50680.030.020	5X20MM	500	50680.050.020	8X25MM	250	50680.080.025
3X25MM	1000	50680.030.025	5X25MM	500	50680.050.025	8X30MM	250	50680.080.030
3X30MM	1000	50680.030.030	5X30MM	500	50680.050.030	8X35MM	100	50680.080.035
			5X40MM	250	50680.050.040	8X40MM	100	50680.080.040
4X6MM	1000	50680.040.006				8X50MM	100	50680.080.050
4X8MM	1000	50680.040.008	6X10MM	500	50680.060.010			

50380 Countersunk head rivet M11F

Material Copper
Packaging Standard



d1 x L	☒	Art.number	d1 x L	☒	Art.number	d1 x L	☒	Art.number
2X6MM	1000	50380.020.006	4X16MM	1000	50380.040.016	6X16MM	500	50380.060.016
2X8MM	1000	50380.020.008	4X20MM	1000	50380.040.020	6X20MM	500	50380.060.020
2X10MM	1000	50380.020.010	4X25MM	500	50380.040.025	6X25MM	250	50380.060.025
			4X30MM	500	50380.040.030	6X30MM	250	50380.060.030
3X6MM	1000	50380.030.006				6X40MM	250	50380.060.040
3X8MM	1000	50380.030.008	5X10MM	1000	50380.050.010	6X50MM	250	50380.060.050
3X10MM	1000	50380.030.010	5X12MM	1000	50380.050.012			
3X12MM	1000	50380.030.012	5X16MM	1000	50380.050.016	8X16MM	250	50380.080.016
3X16MM	1000	50380.030.016	5X20MM	500	50380.050.020	8X20MM	250	50380.080.020
3X20MM	1000	50380.030.020	5X25MM	500	50380.050.025	8X25MM	250	50380.080.025
3X25MM	1000	50380.030.025	5X30MM	500	50380.050.030	8X30MM	250	50380.080.030
			5X40MM	250	50380.050.040	8X40MM	100	50380.080.040
4X8MM	1000	50380.040.008						
4X10MM	1000	50380.040.010	6X10MM	500	50380.060.010			
4X12MM	1000	50380.040.012						