

Taper pin with external thread

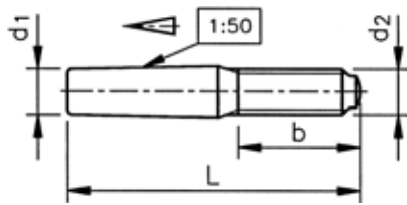

ISO 8737
DIN 7977
NEN 2462



Technical data

d1	d ₂	b
5	M5	14
6	M6	18
8	M8	22
10	M10	24
12	M12	27
16	M16	35
20	M16	35

- d₁ x L: The nominal length (L) is inclusive the rounded ends (tolerance js15).

39011 Taper pin with external thread

L11A

Material Free-cutting steel
Packaging Standard

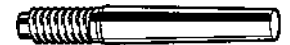

d1 x L	☒	Art.number	d1 x L	☒	Art.number	d1 x L	☒	Art.number
5X40MM	50	39011.050.040	8X75MM	10	39011.080.075	16X85MM	5	39011.160.085
5X45MM	50	39011.050.045	10X60MM	10	39011.100.060	16X100MM	5	39011.160.100
5X50MM	50	39011.050.050	10X65MM	10	39011.100.065	16X120MM	5	39011.160.120
6X45MM	25	39011.060.045	10X75MM	10	39011.100.075	16X140MM	5	39011.160.140
6X50MM	25	39011.060.050	10X85MM	10	39011.100.085	16X160MM	5	39011.160.160
6X55MM	25	39011.060.055	10X100MM	10	39011.100.100	20X100MM	5	39011.200.100
6X60MM	25	39011.060.060	12X85MM	5	39011.120.085	20X120MM	5	39011.200.120
8X55MM	10	39011.080.055	12X100MM	5	39011.120.100	20X140MM	5	39011.200.140
8X60MM	10	39011.080.060	12X120MM	5	39011.120.120	20X160MM	5	39011.200.160
8X65MM	10	39011.080.065						

Taper pin with internal thread ground

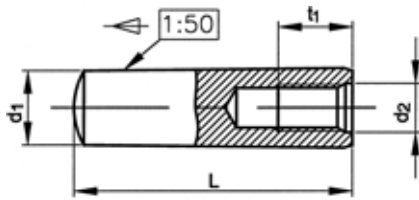

ISO 8736 A
 DIN 7978 A
 NEN 2463
 NF E27-479

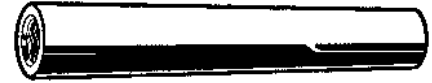

Technical data

d1	d2	t1
6	M4	6
8	M5	8
10	M6	10
12	M8	12
16	M10	16
20	M12	18

- d₁ x L: The nominal length (L) is inclusive the rounded ends (tolerance js15).

39012 Taper pin with internal thread ground

L11A

Material Free-cutting steel
Packaging Standard



d1 x L	☒	Art.number	d1 x L	☒	Art.number	d1 x L	☒	Art.number
6X16MM	50	39012.060.016	8X60MM	10	39012.080.060	12X80MM	5	39012.120.080
6X24MM	50	39012.060.024	8X70MM	10	39012.080.070	12X100MM	5	39012.120.100
6X28MM	50	39012.060.028						
6X30MM	50	39012.060.030	10X24MM	25	39012.100.024	16X40MM	5	39012.160.040
6X32MM	25	39012.060.032	10X28MM	25	39012.100.028	16X50MM	5	39012.160.050
6X36MM	25	39012.060.036	10X32MM	25	39012.100.032	16X60MM	5	39012.160.060
6X40MM	25	39012.060.040	10X40MM	10	39012.100.040	16X80MM	5	39012.160.080
6X50MM	25	39012.060.050	10X50MM	10	39012.100.050	16X90MM	5	39012.160.090
6X60MM	25	39012.060.060	10X60MM	10	39012.100.060	16X100MM	5	39012.160.100
			10X70MM	10	39012.100.070	16X120MM	5	39012.160.120
8X20MM	50	39012.080.020	10X80MM	10	39012.100.080			
8X24MM	25	39012.080.024	10X80MM	10	39012.100.080	20X60MM	5	39012.200.060
8X28MM	25	39012.080.028	10X100MM	10	39012.100.100	20X80MM	5	39012.200.080
8X30MM	25	39012.080.030				20X100MM	5	39012.200.100
8X32MM	25	39012.080.032	12X32MM	10	39012.120.032	20X120MM	5	39012.200.120
8X36MM	25	39012.080.036	12X40MM	10	39012.120.040			
8X40MM	25	39012.080.040	12X50MM	10	39012.120.050			
8X50MM	10	39012.080.050	12X60MM	10	39012.120.060			
			12X70MM	10	39012.120.070			

Parallel pin with internal thread hardened

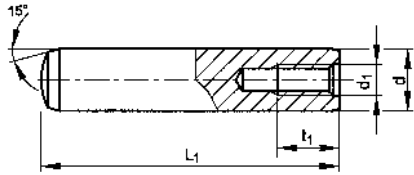

ISO 8735 A
DIN 7979 D
 NEN 2464
 NF E27-475



Technical data

d (m6)	d ₁	t ₁
5 (#DIN)	M3	4
6	M4	6
8	M5	8
10	M6	10

d (m6)	d ₁	t ₁
12	M6	10
14	M8	12
16	M8	12
20	M10	16

d (m6)	d ₁	t ₁
25	M16	24
30	M20	30

- d x L₁: The nominal length (L₁) is inclusive the rounded ends (tolerance js15).

39090 Parallel pin with internal thread hardened

L11A

Material Steel 60 ± 2HRC
Packaging Standard

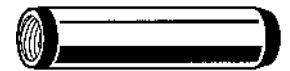

d x L1	☒	Art.number	d x L1	☒	Art.number	d x L1	☒	Art.number
5X12MM	100	39090.050.012	8X40MM	25	39090.080.040	12X60MM	10	39090.120.060
5X16MM	50	39090.050.016	8X45MM	25	39090.080.045	12X70MM	10	39090.120.070
5X20MM	50	39090.050.020	8X50MM	10	39090.080.050	12X80MM	5	39090.120.080
5X24MM	50	39090.050.024	8X60MM	10	39090.080.060	12X100MM	5	39090.120.100
5X28MM	50	39090.050.028	8X70MM	10	39090.080.070			
5X30MM	25	39090.050.030	8X80MM	50	39090.080.080	14X60MM	5	39090.140.060
5X32MM	25	39090.050.032				16X32MM	5	39090.160.032
5X36MM	1	39090.050.036	10X20MM	25	39090.100.020	16X40MM	5	39090.160.040
5X40MM	25	39090.050.040	10X24MM	25	39090.100.024	16X50MM	5	39090.160.050
			10X28MM	25	39090.100.028	16X60MM	5	39090.160.060
6X16MM	50	39090.060.016	10X30MM	25	39090.100.030	16X70MM	5	39090.160.070
6X20MM	50	39090.060.020	10X32MM	25	39090.100.032	16X80MM	5	39090.160.080
6X24MM	50	39090.060.024	10X36MM	10	39090.100.036	16X90MM	5	39090.160.090
6X28MM	50	39090.060.028	10X40MM	10	39090.100.040	16X100MM	5	39090.160.100
6X30MM	50	39090.060.030	10X45MM	10	39090.100.045	16X120MM	5	39090.160.120
6X32MM	25	39090.060.032	10X50MM	10	39090.100.050			
6X40MM	25	39090.060.040	10X60MM	10	39090.100.060	20X50MM	5	39090.200.050
6X45MM	25	39090.060.045	10X70MM	10	39090.100.070	20X60MM	5	39090.200.060
6X50MM	25	39090.060.050	10X80MM	10	39090.100.080	20X70MM	5	39090.200.070
6X60MM	25	39090.060.060				20X80MM	5	39090.200.080
			12X24MM	10	39090.120.024	20X100MM	5	39090.200.100
8X16MM	50	39090.080.016	12X28MM	10	39090.120.028	20X120MM	5	39090.200.120
8X20MM	50	39090.080.020	12X30MM	10	39090.120.030			
8X24MM	25	39090.080.024	12X32MM	10	39090.120.032	25X60MM	5	39090.250.060
8X28MM	25	39090.080.028	12X36MM	10	39090.120.036	25X70MM	5	39090.250.070
8X30MM	25	39090.080.030	12X40MM	10	39090.120.040			
8X32MM	25	39090.080.032	12X45MM	10	39090.120.045			
8X36MM	25	39090.080.036	12X50MM	10	39090.120.050			