

Hexagon weld nut

DIN 929

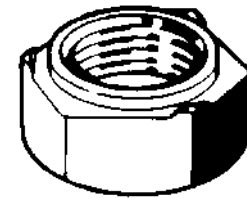
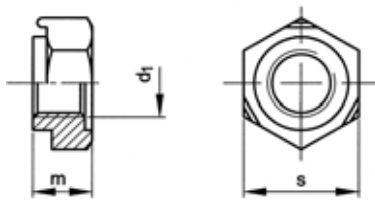

Technical data

d1	P	m (h14)	s (h13)	Hole ø (H11)
M3	0,5	3	7,5	4,5
M4	0,7	3,5	9	6
M5	0,8	4	10	7
M6	1	5	11	8
M8	1,25	6,5	14	10,5
M10	1,5	8	17	12,5
M12	1,75	10	19	14,8
M14	2	11	22	16,8
M16	2	13	24	18,8

Article groups

Thread	Driving features	Material	Packaging	Code	Page
M	hexagon	St Max. 0,25%C	Standard	14020	3-101
M	hexagon	St.St. A2	Standard	51180	3-101
M	hexagon	St.St. A4	Standard	55180	3-101

14020 Hexagon weld nut

F01F

Thread Metric thread
Material Steel Max. 0,25%C
Packaging Standard

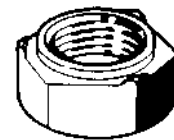

d1	☒	Art.number	d1	☒	Art.number	d1	☒	Art.number
M3	1000	14020.030.001	M6	1000	14020.060.001	M12	100	14020.120.001
M4	1000	14020.040.001	M8	1000	14020.080.001	M14	100	14020.140.001
M5	1000	14020.050.001	M10	500	14020.100.001	M16	100	14020.160.001

- These weld nuts can be used with bolts class < 8.8.

51180 Hexagon weld nut

R09A

Thread Metric thread
Material Stainless steel A2
Packaging Standard

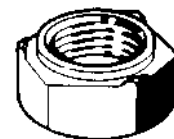

d1	☒	Art.number	d1	☒	Art.number	d1	☒	Art.number
M3	100	51180.030.001	M6	100	51180.060.001	M12	25	51180.120.001
M4	100	51180.040.001	M8	50	51180.080.001	M16	25	51180.160.001
M5	100	51180.050.001	M10	50	51180.100.001			

55180 Hexagon weld nut

R49A

Thread Metric thread
Material Stainless steel A4
Packaging Standard

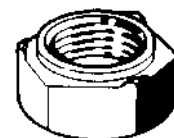

d1	☒	Art.number	d1	☒	Art.number	d1	☒	Art.number
M3	100	55180.030.001	M6	100	55180.060.001	M12	25	55180.120.001
M4	100	55180.040.001	M8	50	55180.080.001	M16	25	55180.160.001
M5	100	55180.050.001	M10	50	55180.100.001			

Weld nut with smooth flange

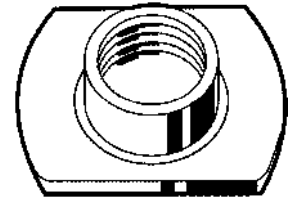
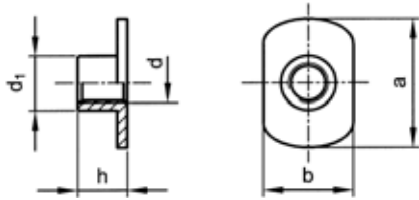

Technical data

	M4	M5	M6	M8	M10
d	M4	M5	M6	M8	M10
P	0,7	0,8	1	1,25	1,5
d ₁	5	6,4	7,7	10,1	11,9
a	17	19	22	26	26
b	9	11	14	18	18
h	6	7,5	8,5	10	10,5

14230 Weld nut with smooth flange

F01F

Thread Metric thread
Material Steel
Packaging Standard

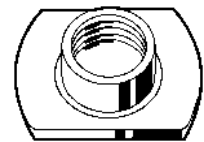

d	☒	Art.number	d	☒	Art.number	d	☒	Art.number
M4	1000	14230.040.001	M6	1000	14230.060.001	M10	500	14230.100.001
M5	1000	14230.050.001	M8	1000	14230.080.001			

3

Spot weld nut

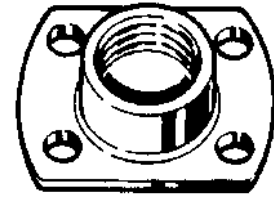
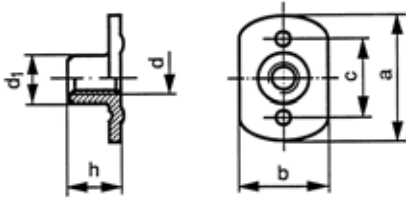

Technical data

d x d1	P	a	b	h	c	Number of welding spots
M3X4,1	0,5	17	9	5	12	2
M4X4,9	0,7	17	9	6	12	2
M4X5	0,7	17	9	6	12	2
M5X6,1	0,8	19	11	7,5	13	2/4
M5X6,4	0,8	19	11	7,5	14	2
M6X7,5	1	22	14	8,5	14	4
M6X7,7	1	22	14	8,5	16	2
M8X9,7	1,25	26	18	11	16	4
M8X10,1	1,25	26	18	10	16	4
M10X11,5	1,5	26	18	10,5	16	4
M10X11,9	1,5	26	18	10,5	16	4

Article groups

Thread	Material	Surface treatment	Packaging	Code	Page
M	St		Standard	14200	3-103
M	St	Zipl	Standard	14210	3-103
M	St.St. A2		Standard	51183	3-103

14200 Spot weld nut

F01F

Thread Metric thread
 Material Steel
 Packaging Standard

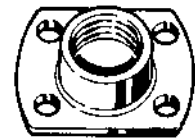

d x d1	Art.number	d x d1	Art.number	d x d1	Art.number
M4x5	1000 14200.040.001	M6x7,7	1000 14200.060.001	M10x11,9	500 14200.100.001
M5x6,4	1000 14200.050.001	M8x10,1	1000 14200.080.001		

14210 Spot weld nut

F01F

Thread Metric thread
 Material Steel
 Surface treatment Zinc plated
 Packaging Standard

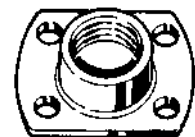

d x d1	Art.number	d x d1	Art.number	d x d1	Art.number
M5x6,4	1000 14210.050.001	M8x10,1	1000 14210.080.001		
M6x7,7	1000 14210.060.001	M10x11,9	500 14210.100.001		

51183 Spot weld nut

R09A

Thread Metric thread
 Material Stainless steel A2
 Packaging Standard

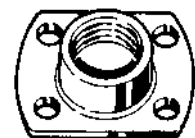

d x d1	Art.number	d x d1	Art.number	d x d1	Art.number
M3x4,1	250 51183.030.001	M5x6,1	250 51183.050.001	M8x9,7	250 51183.080.001
M4x4,9	250 51183.040.001	M6x7,5	250 51183.060.001	M10x11,5	100 51183.100.001

Square weld nut

DIN 928

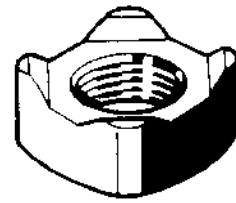
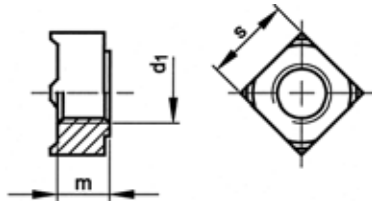

Technical data

d1	P	m (h14)	s (h14)	Hole ø (H11)
M4	0,7	3,5	7	6
M5	0,8	4,2	9	7
M5 (#DIN)	0,8	4,2	8	7
M6	1	5	10	8
M8	1,25	6,5	14	10,5
M10	1,5	8	17	12,5
M12	1,75	9,5	19	14,8
M14	2	11,4	22	16,8

Article groups

Thread	Driving features	Material	Packaging	Code	Page
M	square head	St Max. 0,25%C	Standard	14000	3-104
M	square head	St.St. A2	Standard	51178	3-104

14000 Square weld nut

F01F

Thread	Metric thread
Material	Steel Max. 0,25%C
Packaging	Standard



d1	☒	Art.number	d1	☒	Art.number	d1	☒	Art.number
M4	1000	14000.040.001	M8	1000	14000.080.001	M14	100	14000.140.001
M5	1000	14000.050.001	M10	500	14000.100.001			
M6	1000	14000.060.001	M12	100	14000.120.001			

- These weld nuts can be used with bolts class < 8.8.

51178 Square weld nut

R09A

Thread	Metric thread
Material	Stainless steel A2
Packaging	Standard



d1	☒	Art.number	d1	☒	Art.number	d1	☒	Art.number
M5	100	51178.050.001	M6	100	51178.060.001	M8	50	51178.080.001