

SHIELD ANCHORS - Eye Bolt - Forged

Code	Size	Anchor Hole Size	Eye hole Width	Shield Length	Thread Diameter	Min Hole Depth	Qty Per Box	Qty Per Outer	Weight Kg Per 100	Price £ Per 100
0865YE6	M6	12	10	45	6	50	50	600	3.64	125.71
0865YE8	M8	14	12	50	8	55	50	300	6.16	167.62
0865YE10	M10	16	14	60	10	65	50	200	11.80	250.50
0865YE12	M12	20	16	75	12	85	25	100	19.84	446.59

SHIELD ANCHORS - Hook Bolt

Code	Size	Anchor Hole Size	Shield Length	Thread Diameter	Min Hole Depth	Qty Per Box	Qty Per Outer	Weight Kg Per 100	Price £ Per 100
0865H6	M6	12	45	6	50	50	600	3.68	125.71
0865H8	M8	14	50	8	55	50	300	6.84	167.62
0865H10	M10	16	60	10	65	50	200	11.96	250.50
0865H12	M12	20	75	12	85	25	100	22.40	446.59

SHIELD ANCHORS - Shield Only

Code	Size	Anchor Hole Size	Shield Length	Thread Diameter	Min Hole Depth	Qty Per Box	Qty Per Outer	Weight Kg Per 100	Price £ Per 100
0865S6	M6	12	45	6	50	50	900	1.84	46.41
0865S8	M8	14	50	8	55	50	900	2.56	68.39
0865S10	M10	16	60	10	65	50	600	3.80	85.32
0865S12	M12	20	75	12	85	25	300	7.36	166.11
0865S16	M16	25	115	16	125	10	120	16.60	349.27

Technical Information Shield Anchors - Hook and Eye Bolt

Thread Diameter (size)	Hole Diameter (mm)	Hole Depth (mm)	Centre Spacing (mm)	Edge Distance (mm)	Forged Eye Bolt Tensile Load kN	Pressed Eye Bolt Tensile Load kN	Forged Hook Bolt Tensile Load kN	Rec Tight Torque Nm
M6	12	50	120	80	1.6	0.6	0.6	6.5
M8	14	55	150	100	2.9	1.0	1.0	15
M10	16	65	180	120	4.6	1.3	1.7	24
M12	20	85	250	160	6.9	2.2	2.5	50

For loads for 30 N/mm² CONCRETE.

The Shield Anchor is the most popular anchor, internally threaded for fixing into masonry and concrete. Ideal general purpose anchor bolt, suitable for variations in hole size.

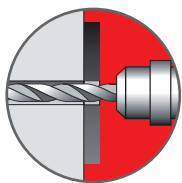

Drill your hole to the correct diameter...

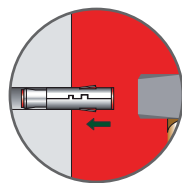

...tap in anchor...

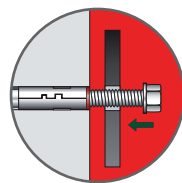

...insert Shield Anchor into hole...

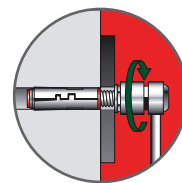

...tighten to recommended tightening torque.

